

D. D. A. DWARKA PROJECT

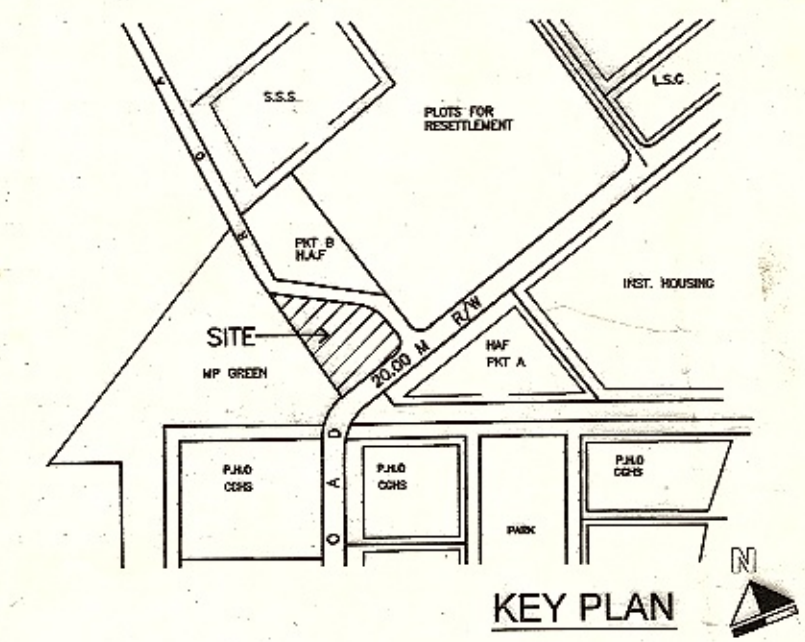

AREA STATEMENT

TOTAL PLOT AREA : 5190 SQM.

S.No.	USES	AREA
1	CENTRE FOR WELFARE OF PERSONS WITH AUTISM, CEREBRAL PALSY MENTAL RETARDATION AND MULTIPLE DISABILITIES	3190 SQM. APROX.
2	CENTRE FOR MENTALLY CHALLENGED WOMEN	2000 SQM.

NOTE :

1. THIS DRG. HAS BEEN PREPARED ON THE BASIS OF PT SURVEY GIVEN BY AD (SURVEY)DWARKA.DATED 6-5-09.
2. FILE NO. F.4(3) 08/PLG. /DWK/PT.II.
3. APPROVED IN 278TH SCREENING COMMITTEE DATED 8-05-2009 VIDE ITEM NO. 78:2009.
4. THE DEVELOPMENT CONTROL NORMS FOR SCHOOL FOR MENTALLY CHALLENGED / PHYSICALLY CHALLENGED WILL BE APPLICABLE.

SUB-DIVISION OF SITE FOR SCHOOL FOR HANDICAP IN SECTOR- 3,DWARKA, PHASE-I.

SCALE : 1: 500	DRG.NO.DWK/SEC.-3/SUB.DIVN./HS/09/60		
<i>[Signature]</i> PLG. D/ MAN	<i>[Signature]</i> PLG. ASST.	8-5-09 DATE	N NORTH
<i>[Signature]</i> ASST. DIR. (PLG.)	<i>[Signature]</i> JT. DIRECTOR (PLG.)	<i>[Signature]</i> 13/6/2009 DIRECTOR (PLG.)	

DELHI DEVELOPMENT AUTHORITY

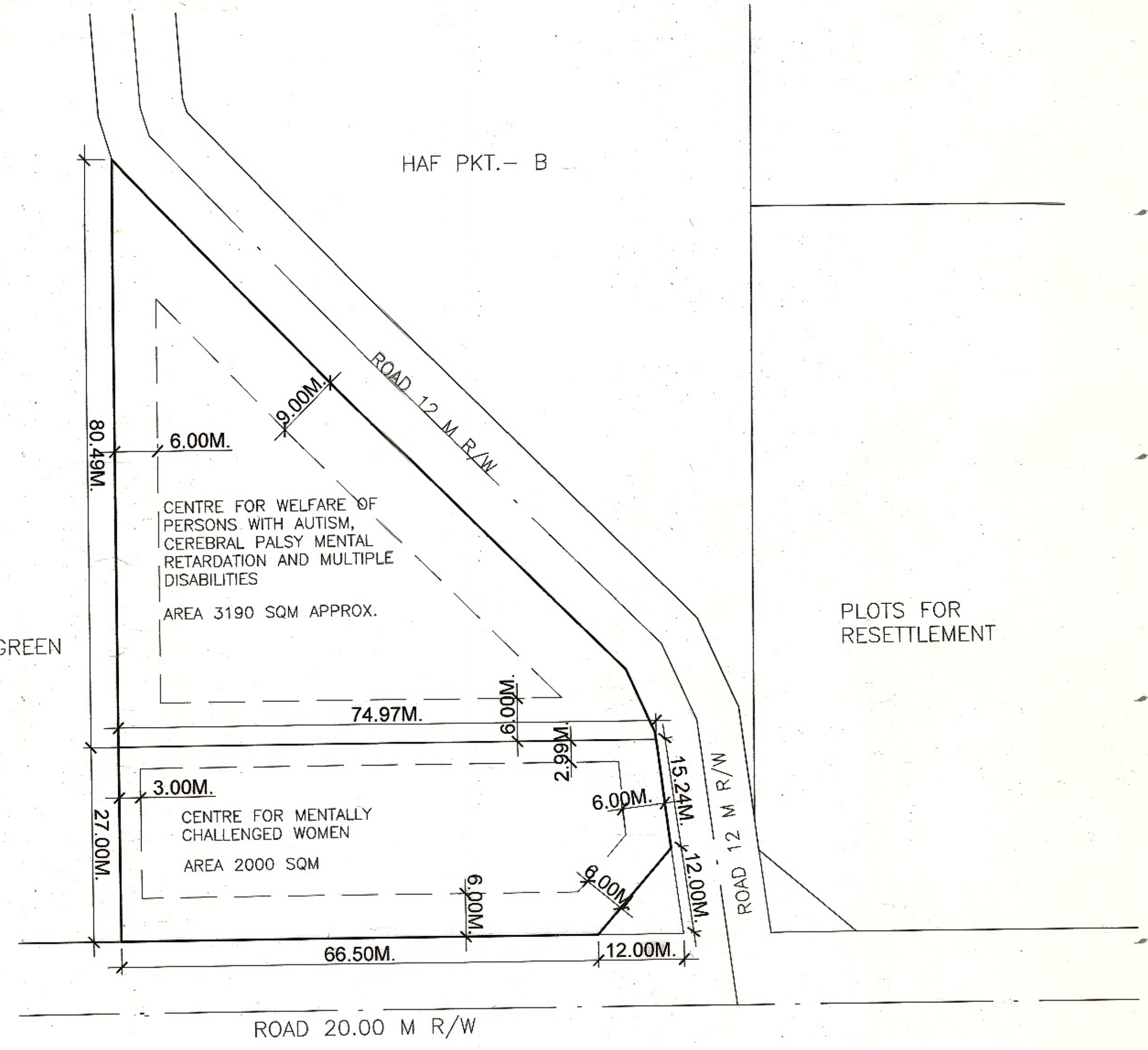

M.P. GREEN

HAF PKT.- B

PLOTS FOR RESETTLEMENT

HAF PKT. -A